



DISTRICT WIDE CAPITAL PROJECT PRESERVING OUR FACILITIES AND PREPARING FOR THE FUTURE

HUNT

BUILDING CONDITION SURVEY WORK

- | | | |
|---|--|---|
| <ul style="list-style-type: none"> NURSE SUITE IMPROVEMENTS:
• CASEWORK UPGRADES
• FLOOR FINISH REPLACEMENT
• CEILING REPLACEMENT
PHASE 1 CLASSROOM IMPROVEMENTS:
• SECURITY HARDWARE
• UPGRADE TO IP PAGING & CLOCK SYSTEM
PHASE 1 & 2 | <ul style="list-style-type: none"> CLASSROOM IMPROVEMENTS:
• CASEWORK UPGRADES
• FLOOR FINISH REPLACEMENT
• CEILING REPLACEMENT
• WALL TILE WAINSCOT REPLACEMENT
• SECURITY HARDWARE
• UPGRADE TO IP PAGING & CLOCK SYSTEM
PHASE 1 & 2 GYMNASIUM RENOVATIONS:
• FLOOR FINISH REPLACEMENT
• WALL PAD REPLACEMENT
• MASONRY WALL REPAIR
• MECHANICAL EQUIPMENT REPLACEMENT
• LIGHTING REPLACEMENT
PHASE 1 REPLACE CORRIDOR WALL TILE
PHASE 1 | <ul style="list-style-type: none"> REPLACE EXISTING BUS LIFT AND PROVIDE ADDITIONAL SMALL VEHICLE LIFT
PHASE 1 & 2 TV STUDIO IMPROVEMENTS:
• REMOVE SPACE TO MEET CURRICULUM NEEDS
• UPDATE EQUIPMENT
PHASE 2 KITCHEN IMPROVEMENTS:
• EQUIPMENT REPLACEMENT
• REPAIR EXISTING HOOD AND PROVIDE ADDITIONAL HOOD FOR OVEN
• MODIFY SERVING LINE TO ACCOMMODATE STUDENT FLOW
PHASE 2 AUDITORIUM IMPROVEMENTS:
• CEILING REPLACEMENT
• PROVIDE ADDITIONAL EQUIPMENT
PHASE 2 |
|---|--|---|



HIGH SCHOOL/MIDDLE SCHOOL FIRST FLOOR PLAN



ELEMENTARY FIRST FLOOR PLAN

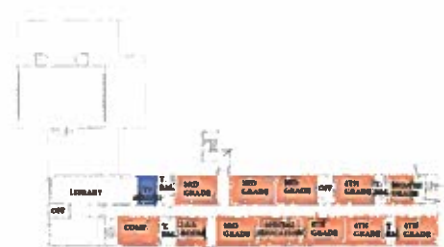

ELEMENTARY SECOND FLOOR PLAN



OPERATIONS FACILITY FLOOR PLAN

WORK NOT SHOWN

- PHASE 1**
 - REPLACE NON CODE COMPLIANT DOORS
 - REPLACE FLOOR FINISH IN ES LIBRARY & KINDERGARTEN CORRIDOR
 - INTERIOR & EXTERIOR MASONRY REPAIR AT ES
 - REPLACE EXTERIOR CONCRETE STAIR AT ES MECHANICAL ROOM
 - HS BOILER PUMP REPLACEMENT
 - POOL FILTRATION EQUIPMENT REPLACEMENT
 - ARC FLASH LABELING
- PHASE 2**
 - PROVIDE OFFICE VENTILATION
 - PROVIDE BROADCASTING CAPABILITIES AT FIELD HOUSE & AUDITORIUMS

WATKINS GLEN

CENTRAL SCHOOL DISTRICT



DISTRICT WIDE CAPITAL PROJECT PRESERVING OUR FACILITIES AND PREPARING FOR THE FUTURE

HUNT

BUILDING CONDITION SURVEY WORK

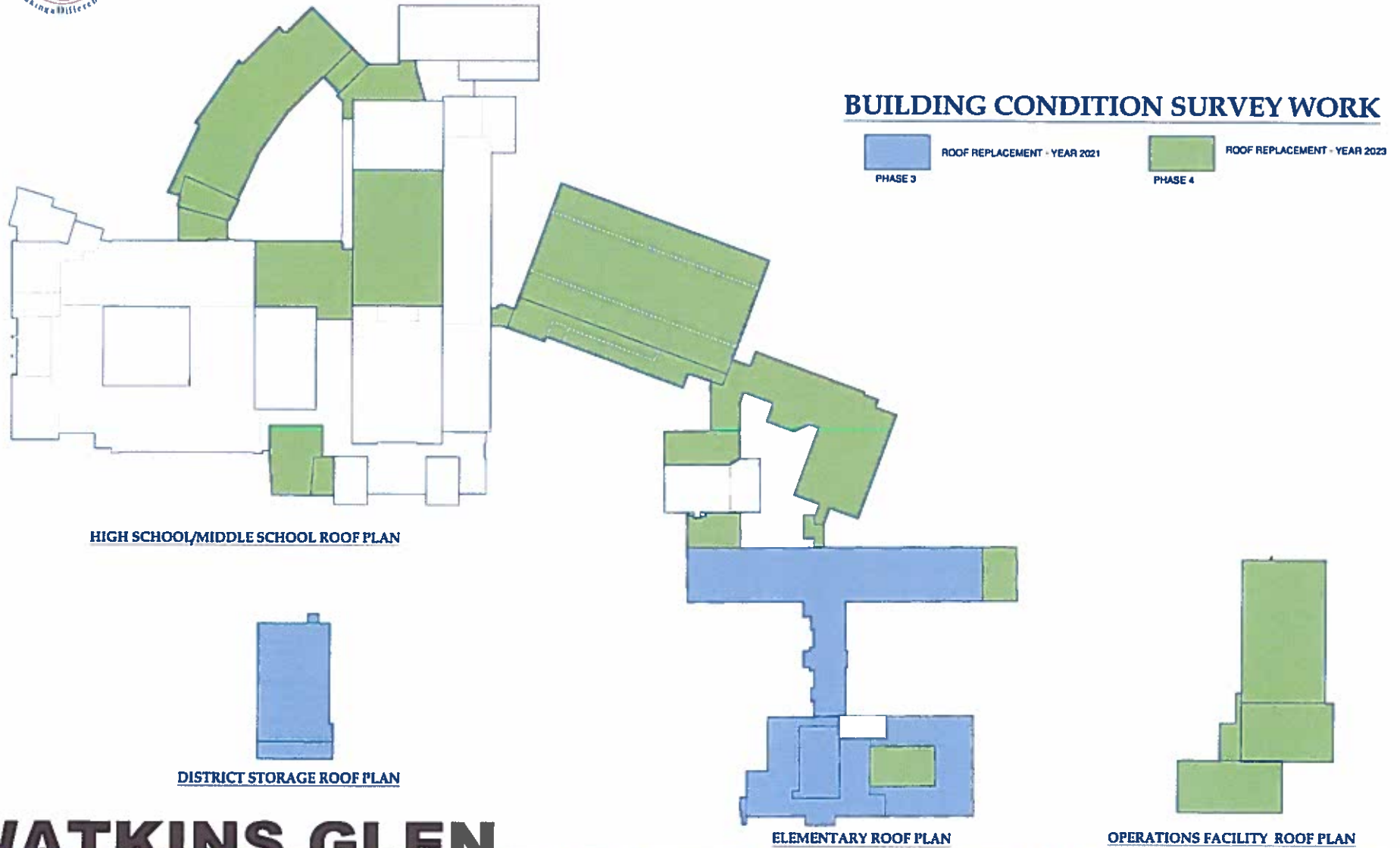

WATKINS GLEN

CENTRAL SCHOOL DISTRICT



DISTRICT WIDE CAPITAL PROJECT PRESERVING OUR FACILITIES AND PREPARING FOR THE FUTURE

HUNT



SITE WORK

- PHASE 1
- UPDATE EXTERIOR LIGHTING AT BLEACHERS
 - SYNTHETIC TURF AT STADIUM, BASEBALL & SOFTBALL FIELDS
 - PAVE UTILITY ACCESS ROAD
 - STADIUM FENCE IMPROVEMENTS
 - ADDITIONAL TENNIS COURT
 - SIDEWALK REPAIRS
 - PLAYGROUND SURFACING IMPROVEMENTS

WATKINS GLEN

CENTRAL SCHOOL DISTRICT